

## PROJECT NAME: FORRESTE (P-1146)

Forreste, Jethalaj, Rancharda - Khartraj Road



Property Type:	Villa/Bungalows
Builder Name:	Arvind Smartspaces
Locality:	Jethalaj
City:	Ahmedabad
State:	Gujarat
Availability:	01-12-2024
Project Type:	Ongoing
Sample House Ready:	No

Rera ID: PR/GJ/GANDHINAGAR/GANDHINAGAR/AUDA/RAA06788/A1R/210620

Description: Exclusive & Premium 1,2,3 & 4 BHK Villa.

Architect Name: KRUNAL PATEL      Structure Consultant: HIRAL MAKADIA

Property Facilities: Wooden Floor      Wash Room      Vastu Compliant

Building Amenities:

CCTV Camera	Garden	Fire Safety
Gym	Power Backup	Swimming Pool
Security	Club House	Library
Theater	Multi Purpose Hall	House Keeping
Borewell	Kid's Play Area	Tt & Billiard
Cafeteria	Games Room	Waste Disposal
Vastu Compliant	Sauna & Steam	Boom Barrier
Jogging Track	Skating Ring	Multi Purpose Court
Open Theater (Amphitheater)		

## Specification:

Structure :	Earthquake Resistant RCC Frame Structure. External and internal partition walls with good quality cement blocks / clay bricks.
Interior Walls :	Internal: Putty finish. External: Combination of natural stones, tiles and premium emulsion paint as per villa elevation designs. Balcony, Terrace and Staircase Railing: Mild steel railing or Equivalent.
Flooring :	Living, Dining: Natural marble / stone, artificial stone, premium vitrified / porcelain tiles / Rustic tiles or Equivalent Stone / Tile. Bedrooms: Premium wooden laminate flooring or premium vitrified / porcelain tiles or Equivalent tiles. Kitchen: Vitrified / Porcelain tiles or Equivalent tiles. Bathrooms and Kitchen Dado: Vitrified / Ceramic / Porcelain or Equivalent tiles. Balcony and Utility: AntiSkid Vitrified / Ceramic/ Porcelain or Equivalent tiles. Verandah: Natural marble / Stone, artificial stone, premium vitrified / porcelain tiles / Rustic tiles or Equivalent stone/tile.
Doors :	Main Door: Teak finish / Veneer finish / Engineered doors or Equivalent. Door frames: Maranti / Engineered door frame or Equivalent. Maranti / Engineered door frame or Equivalent. Internal Rooms Door: Flush doors with both side laminate / Engineered Maranti / Engineered door frame or Equivalent. Bathroom Doors: Rooms Door: Flush doors with both side laminate / Engineered Maranti / Engineered door frame or Equivalent. Door Hardware: Ozone, Dorest, Kich and Equivalent.
Electrical :	Fixtures Premium brands like Anchor / ABB, Siemens / Havells or Equivalent.
Kitchen :	Kitchen Platform: Optional at cost Polished Granite or Equivalent stone. Basin Counter: Polished Granite or Equivalent stone.
Doors & Windows :	Jindal (1" Series) / Equivalent Heavy Duty Aluminium Powder Coated Windows / UPVC Heavy Duty Windows. Optional at cost Windows with sound resistance glass and provision of mosquito mesh. Aluminum Windows.
Plumbing :	CP Fittings and Accessories: Premium brands like Hindware / Cera /Somany /Jaguar or Equivalent. Sanitary Ware: Wall / Floor mounted Sanitary Ware from Jaguar / Cera / Somany or Equivalent.

## PROJECT DETAILS

Sr. No.	Type	Constructed Area (SBA)	Area Unit
1	1 BHK	558/928 sqft super builtup	Sq. Ft.
2	2 BHK	1500 sqft super builtup	Sq. Ft.
3	3 BHK	1849 sqft super builtup	Sq. Ft.
4	4 BHK	2313 sqft super builtup	Sq. Ft.

- Stamp duty, Registration charges, Legal charges, Auda, Electricity, Corporation, Parking and all other extra charges shall be borne by the purchaser.

- GST, TDS and any other taxes levied in future shall be borne by the purchaser.

## PROPERTY PHOTOS

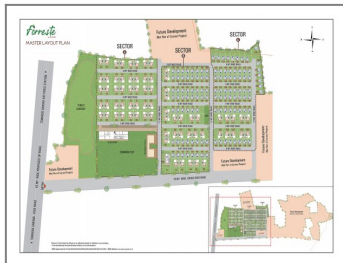
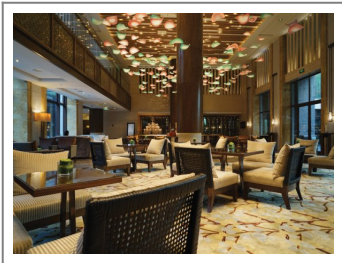
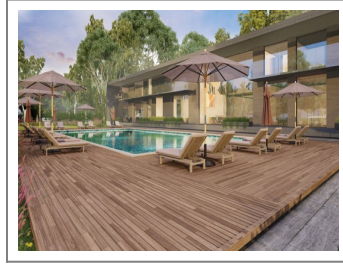

**Note :** All visuals, images, facilities and other details shown here are for presentation only and are subject to change by the builder/developer/owner without any obligation.

**Disclaimer :** onestopproperty.in is an online Real Estate platform for Seller and Agent/Broker/Customer/Buyer to facilitate their real estate needs. One Stop Property cannot control any transactions between the Seller and the Agent/Broker/Customer/Buyer. Properties details displayed on the onestopproperty.in website are for informational purposes only. Information regarding real estate projects including property/project details, by various Builder(s)/Developer(s)/Broker(s) who have advertised their property/project. Nothing contained herein shall be deemed to constitute legal advice, solicitations, marketing, offer for sale, invitation to offer, invitation to acquire by the developer/builder or any other entity. One Stop Property Solutions Pvt Ltd shall neither be responsible nor liable to mediate or resolve any disputes or disagreements between the Seller and Agent/Broker/Customer/Buyer. Hereby we strongly advised to visit the relevant RERA website before taking any decision based on the contents displayed on the website.