

PROJECT NAME: SHIVALIK LAKEVIEW (P-1019)

Opp. Sanskardham Lane, Nr. Manipur Lake, Bopal-ghuma Road



Property Type:	Villa/Bungalows
Builder Name:	Shivalik Group
Locality:	Manipur
City:	Ahmedabad
State:	Gujarat
Availability:	15-09-2021
Project Type:	Ongoing
Sample House Ready:	Yes

Rera ID: PR/GJ/AHMEDABAD/SANAND/AUDA/RAA05694/110719,
PR/GJ/AHMEDABAD/SANAND/AUDA/RAA05388/040519

Description 4 B H K LUXURIOUS BUNGALOWS

Architect Name: janki Vyas Structure Consultant Sarjan Consultants

Property Facilities: Intercom Wash Room

Building Amenities: CCTV Camera Garden Fire Safety
Visitor Parking Gym Swimming Pool
Security Piped Gas Club House
Temple Borewell Kid's Play Area
Tt & Billiard Wash Room Games Room
Gated Community

Specification:

Structure :	EARTHQUAKE RESISTANT STRUCTURAL DESIGN
Interior Walls :	EXTERNAL DOUBLE COAT PLASTER WITH ACRYLIC PAINT, INTERIOR MALA PLASTER (WITH PUTTY FINISH)
Flooring :	VITRIFIED FLOORING IN DRAWING, DINING, BEDROOMS AND KITCHEN,RUSTIC TILES IN BALCONY,GRANITE STAIRCASE,MASTER BEDROOM WOODEN FLOORING,CHINA MOSAIC IN TERRACE AREA FOR WATER PROOFING & HEAT RESISTANCE
Electrical :	CONCEALED COPPER WIRING WITH MODULAR SWITCHES ADEQUATE POWER SUPPLY FROM GEB
Toilet :	DESIGNER TILES IN ALL TOILETS UP TO LINTEL LEVEL, BRANDED BATH FITTING, STANDARD QUALITY OF SANITARY WARE, OVERHEAD WATER TANK
Sanitary Ware :	High Quality Sanitaryware and Accessories
Security Camera :	24 X 7 Security Surveillance
Elevator :	Automatic high speed elevators of a Reputed Brand
Kitchen :	GRANITE PLATFORM, TILES DADO UP TO LINTEL LEVEL, STORE WITH KOTA STONE SHELVES, WASH AREA PAVED IN KOTA STONE
Doors & Windows :	DECORATIVE MAIN DOOR WITH WOODEN FRAME, INTERNAL FLUSH DOORS, FULLY ANODIZED ALUMINIUM SLIDING WINDOWS WITH GRANITE SEAL
Plumbing :	Good Quality Plumbing Supply

PROJECT DETAILS

Sr. No.	Type	Constructed Area (SBA)	Plot Area (SBA)	Area Unit
1	4 BHK	376 - 456 Sq yard Super builtup	292 - 790 Sq yard Super builtup	Sq. Yrd.

- Stamp duty, Registration charges, Legal charges, Auda, Electricity, Corporation, Parking and all other extra charges shall be borne by the purchaser.
- GST, TDS and any other taxes levied in future shall be borne by the purchaser.

PROPERTY PHOTOS

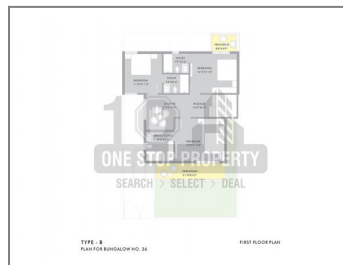
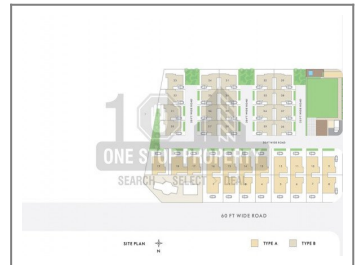
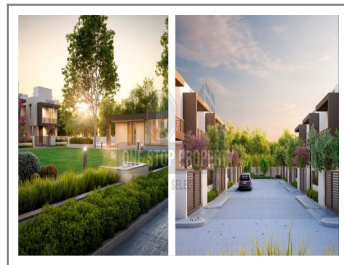
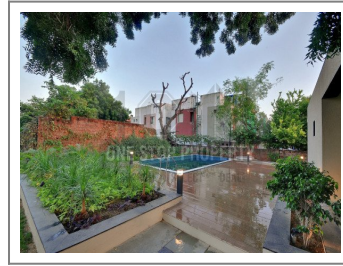
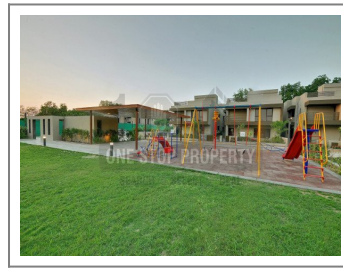

Note : All visuals, images, facilities and other details shown here are for presentation only and are subject to change by the builder/developer/owner without any obligation.

Disclaimer : onestopproperty.in is a online Real Estate platform for Seller and Agent/Broker/Customer/Buyer to facilitate their real estate needs. One Stop Property cannot control any transactions between the Seller and the Agent/Broker/Customer/Buyer. Properties details displayed on the onestopproperty.in website are for informational purposes only. Information regarding real estate projects including property/project details, by various Builder(s)/Developer(s)/Broker(s) who have advertised their property/project. Nothing contained herein shall be deemed to constitute legal advice, solicitations, marketing, offer for sale, invitation to offer, invitation to acquire by the developer/builder or any other entity. One Stop Property Solutions Pvt Ltd shall neither be responsible nor liable to mediate or resolve any disputes or disagreements between the Seller and Agent/Broker/Customer/Buyer. Hereby we strongly advised to visit the relevant RERA website before taking any decision based on the contents displayed on the website.